

# EXHIBIT F. HOLLY RIDGE NORTHEAST SITE, EXISTING AND PROPOSED POTABLE WATER INFRASTRUCTURE MAP

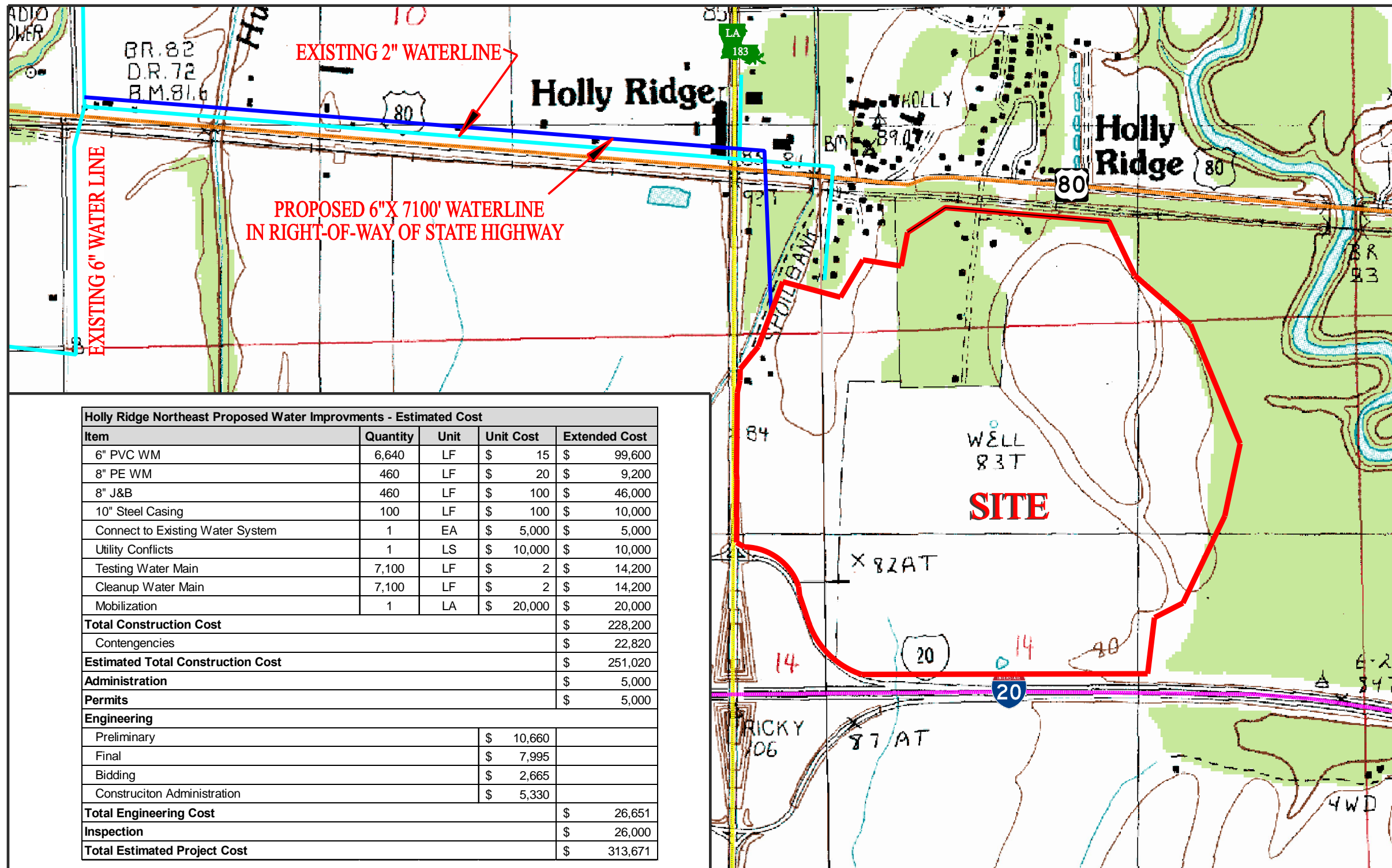

Holly Ridge Northeast Proposed Water Improvements - Estimated Cost				
Item	Quantity	Unit	Unit Cost	Extended Cost
6" PVC WM	6,640	LF	\$ 15	\$ 99,600
8" PE WM	460	LF	\$ 20	\$ 9,200
8" J&B	460	LF	\$ 100	\$ 46,000
10" Steel Casing	100	LF	\$ 100	\$ 10,000
Connect to Existing Water System	1	EA	\$ 5,000	\$ 5,000
Utility Conflicts	1	LS	\$ 10,000	\$ 10,000
Testing Water Main	7,100	LF	\$ 2	\$ 14,200
Cleanup Water Main	7,100	LF	\$ 2	\$ 14,200
Mobilization	1	LA	\$ 20,000	\$ 20,000
<b>Total Construction Cost</b>				\$ 228,200
Contingencies				\$ 22,820
<b>Estimated Total Construction Cost</b>				\$ 251,020
<b>Administration</b>				\$ 5,000
<b>Permits</b>				\$ 5,000
<b>Engineering</b>				
Preliminary			\$ 10,660	
Final			\$ 7,995	
Bidding			\$ 2,665	
Construction Administration			\$ 5,330	
<b>Total Engineering Cost</b>				\$ 26,651
<b>Inspection</b>				\$ 26,000
<b>Total Estimated Project Cost</b>				\$ 313,671



### LEGEND

PROPERTY BOUNDARY



SOURCE: USGS TOPOGRAPHIC QUADRANGLE: BEE BAYOU & DUNN

Cost only to connect Site to existing water system.  
 Local water system to be improved in accordance with  
 Exhibit G: Utility Feasibility Study Potable Water  
 Franklin Farms Mega Site Report

Prepared By  
**DENMON**  
 ENGINEERING  
 ENGINEERS AND SURVEYORS  
 114 VENABLE LANE  
 MONROE, LOUISIANA 71203