

# EXHIBIT G, PETTY SOUTH SITE EXISTING WASTEWATER INFRASTRUCTURE MAP

OUACHITA  
PARISH

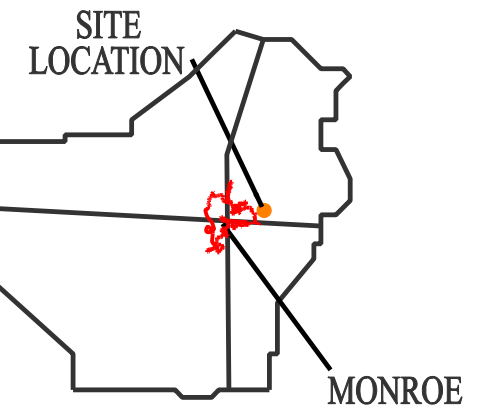

**LEGEND**

PROPERTY BOUNDARY

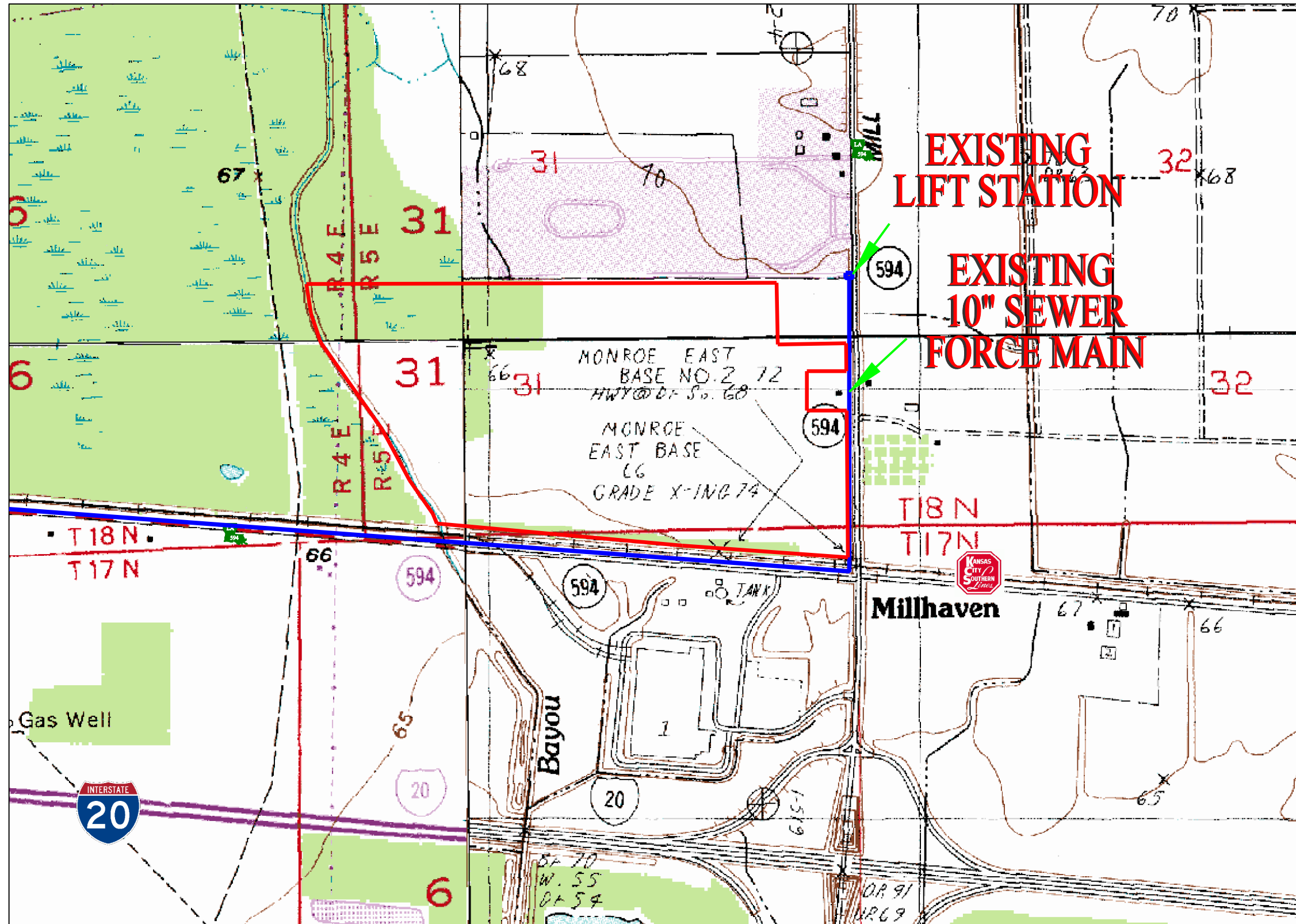

EXISTING CAPACITY (CITY OF MONROE): 336,000 GPD



SOURCE: USGS TOPOGRAPHIC QUADRANGLE: CREW LAKE, SWARTZ, MONROE SOUTH, & MONROE NORTH

Prepared By  
**DENMON**  
ENGINEERING  
ENGINEERS AND SURVEYORS  
114 VENABLE LANE  
MONROE, LOUISIANA 71203