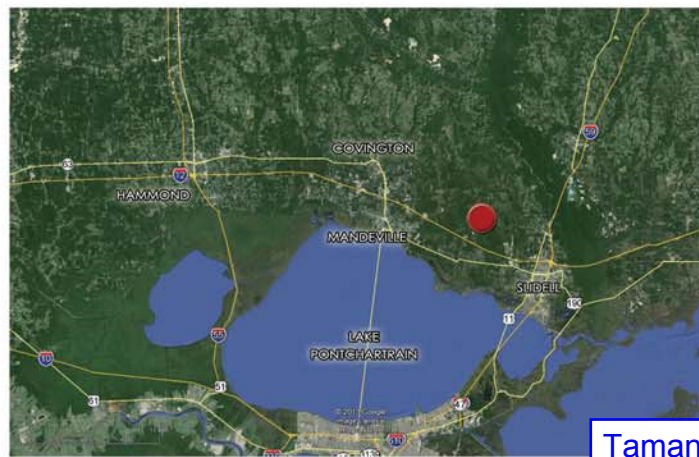

Exhibit GG. Tamanend Business Park West Site Master Plan



Tamanend Business Park West Site Master Plan



Tamanend Business Park West Site

VICINITY MAP

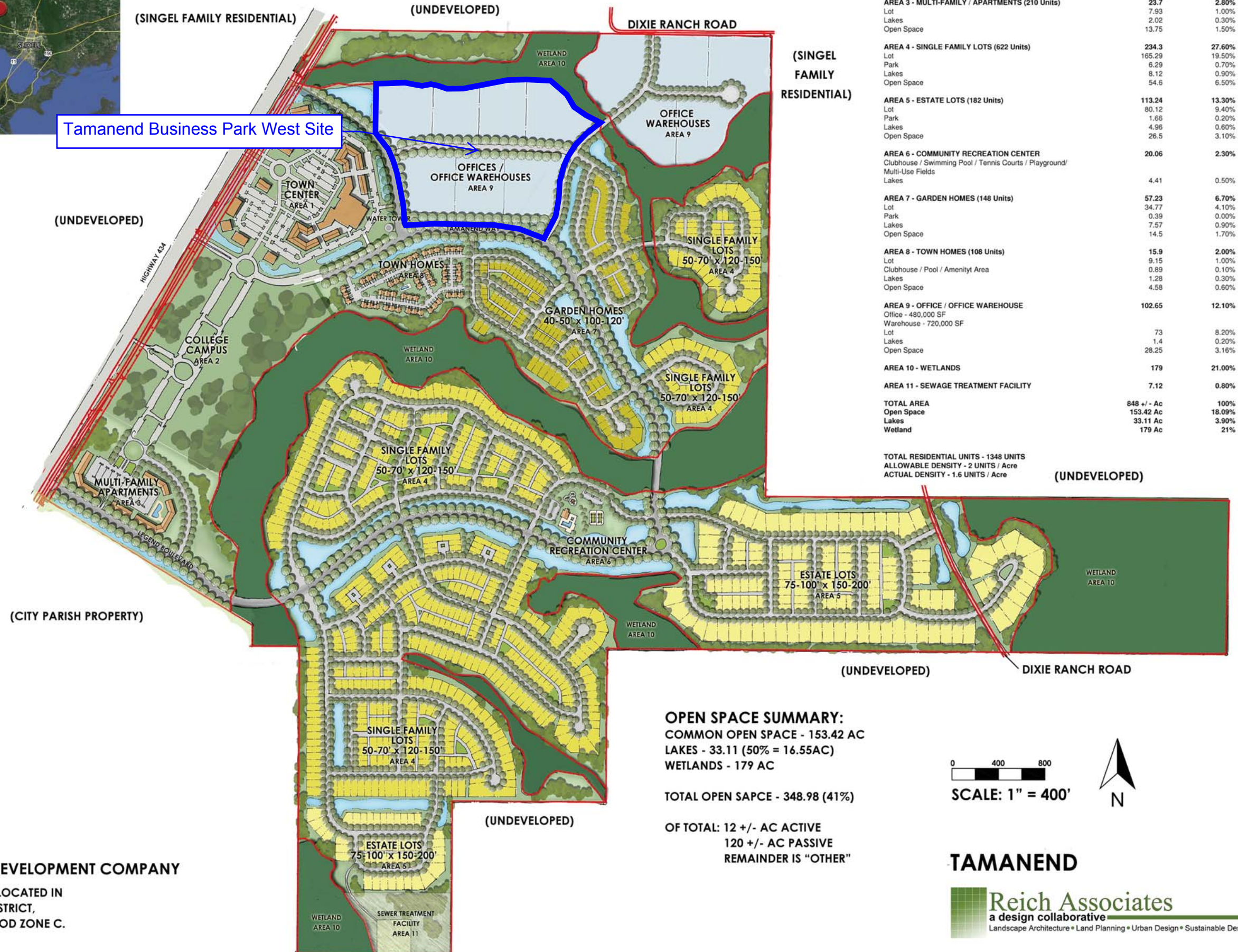

OWNER: WEYERHAEUSER REAL ESTATE DEVELOPMENT COMPANY

TAMANEND: A 848.26 ACRE PORTION OF GROUND LOCATED IN SECTIONS 3,4, & 9, T85-R13E, GREENSBURG LAND DISTRICT, ST. TAMMANY PARISH, LOUISIANA. LOCATED IN FLOOD ZONE C.

OPEN SPACE SUMMARY:
COMMON OPEN SPACE - 153.42 AC
LAKES - 33.11 (50% = 16.55AC)
WETLANDS - 179 AC

TOTAL OPEN SAPCE - 348.98 (41%)

OF TOTAL: 12 +/- AC ACTIVE
120 +/- AC PASSIVE
REMAINDER IS "OTHER"

TAMANEND

