

## Exhibit O. Foti - Highway 18 Geological Survey Quad Map





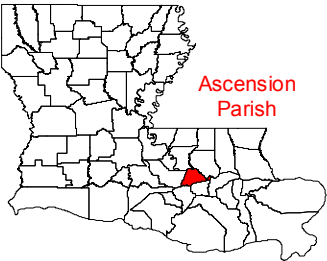
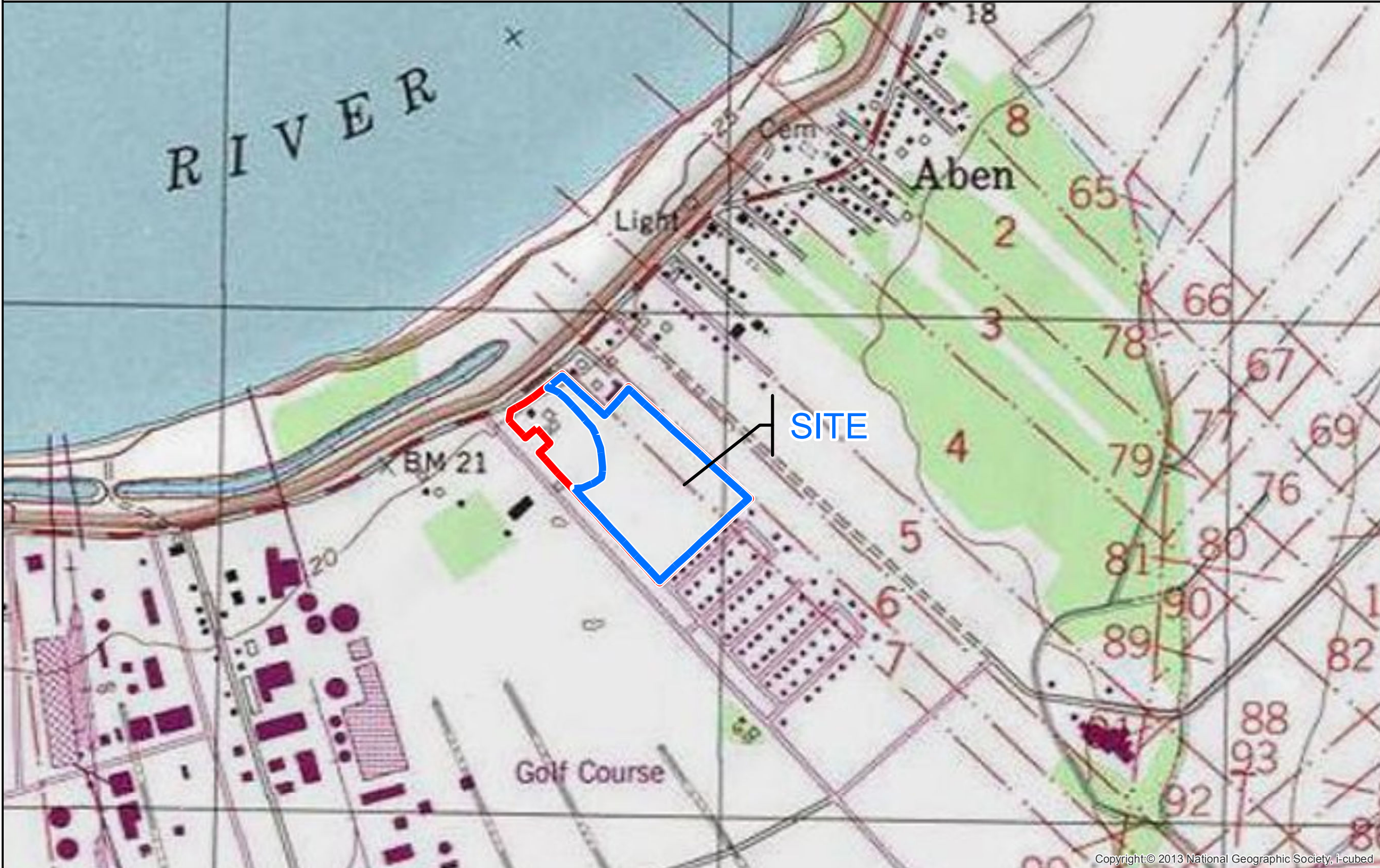

Document Path: R:\DWG\16-000\16-392\Foti Sites\Foti - Hwy 18\Maps\Program Application Exhibits\Exhibit O - U.S. Geological Survey Quad Map.mxd

# Foti - Highway 18 U.S. Geological Survey Quad Map



- LEGEND**
-  Foti - Highway 18 (± 22.70 Ac.)
  -  LED Certified Site Area (± 17.73 Ac.)



SITE NAME: Foti - Highway 18

Drawn By: CDS

Checked By: GJB

Date: 6/4/2018

**General Notes:**  
1. The information presented herein was obtained from various resources and should be considered preliminary.  
2. No attempt has been made by Duplantis Design Group, PC to verify site boundary, title, actual legal ownership, deed restrictions, servitudes, easements, or other burdens on the property.

**References:**  
1. Topo and symbologies from U.S. Geological Survey, National Geographic, i-cubed  
2. Site boundary from Landsource, Inc.

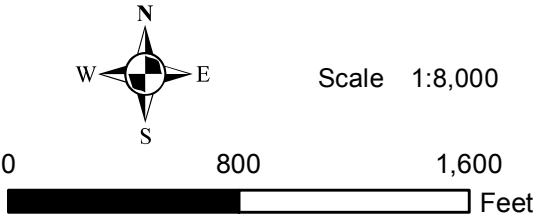

**DDG**  
DUPLANTIS DESIGN GROUP  
8352 Bluebonnet Blvd.  
Baton Rouge, LA 70810  
Phone: 225-751-4490  
www.ddgpc.com