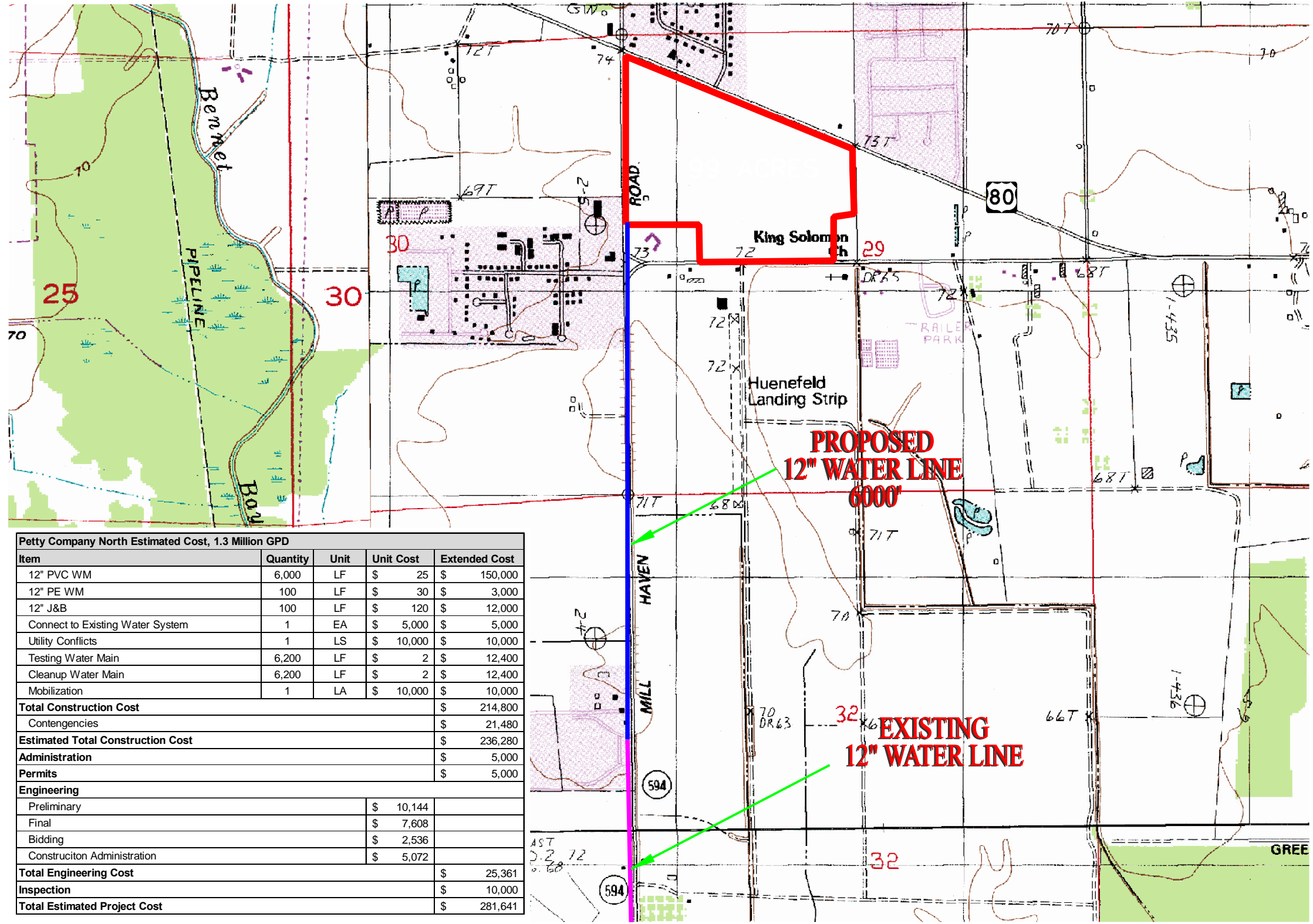
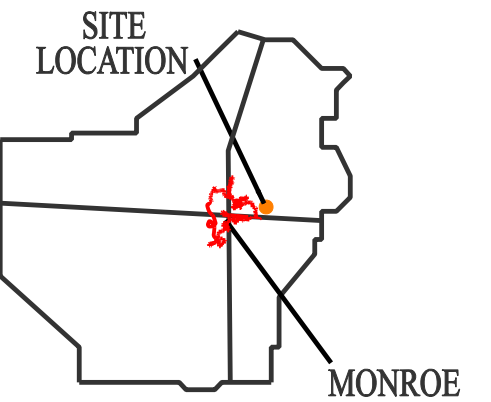

EXHIBIT F PETTY NORTH SITE EXISTING & PROPOSED POTABLE WATER INFRASTRUCTURE

OUACHITA
PARISH



Petty Company North Estimated Cost, 1.3 Million GPD				
Item	Quantity	Unit	Unit Cost	Extended Cost
12" PVC WM	6,000	LF	\$ 25	\$ 150,000
12" PE WM	100	LF	\$ 30	\$ 3,000
12" J&B	100	LF	\$ 120	\$ 12,000
Connect to Existing Water System	1	EA	\$ 5,000	\$ 5,000
Utility Conflicts	1	LS	\$ 10,000	\$ 10,000
Testing Water Main	6,200	LF	\$ 2	\$ 12,400
Cleanup Water Main	6,200	LF	\$ 2	\$ 12,400
Mobilization	1	LA	\$ 10,000	\$ 10,000
Total Construction Cost				\$ 214,800
Contingencies				\$ 21,480
Estimated Total Construction Cost				\$ 236,280
Administration				\$ 5,000
Permits				\$ 5,000
Engineering				
Preliminary			\$ 10,144	
Final			\$ 7,608	
Bidding			\$ 2,536	
Construction Administration			\$ 5,072	
Total Engineering Cost				\$ 25,361
Inspection				\$ 10,000
Total Estimated Project Cost				\$ 281,641

LEGEND

— PROPERTY BOUNDARY



ECONOMIC ALLIANCE

NELEA

LED LOUISIANA ECONOMIC DEVELOPMENT

Prepared By
DENMON
 ENGINEERING
 ENGINEERS AND SURVEYORS
 114 VENABLE LANE
 MONROE, LOUISIANA 71203

EXISTING CAPACITY: 1,300,000 GPD, CITY OF MONROE

SOURCE: USGS TOPOGRAPHIC QUAD MAP, MONROE NORTH, MONROE SOUTH, SWARTZ & CREW LAKE