

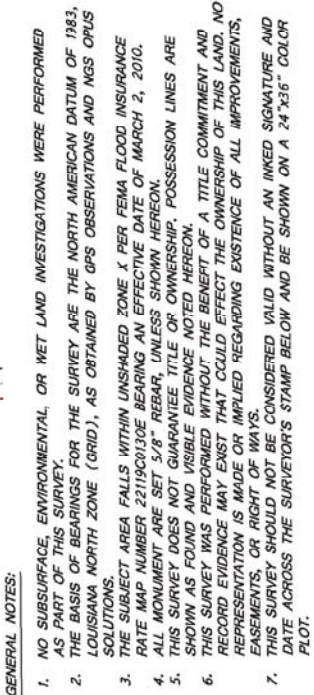

NORTH WALES SHEEP & HORSE SHOWS
INDUSTRIAL DISTRICT



1. No attempt has been made by CSRS, Inc. to verify title, actual legal ownership, deed restrictions, servitudes, easements, or other burdens on the property, other than that furnished by the client or his representative.

2. Depicted exhibit based on survey by James Cody Goodwin titled, "Map of Survey Ordered By The North Webster Parish Industrial District of Land in Part of the NE/4 Section 25 Township 23 North Range 11 West Webster Parish Louisiana," dated 3/27/2015.

GENERAL NOTES:

WIN PROFESSIONAL SERVICES, LLC
UTLER STREET
CHILL 1A 71075



Project:

Client:

SCALE: 1"=200'



visions:

Key Plan:

 SITE BOUNDARY
(61.33 AC. ±)

 R/W, EASEMENTS,
& SERVITUDES
(9.04 AC. ±)

Sheet Title:

| | |
|-----------------|----------|
| Date: | MAY 2015 |
| Project Number: | 215040 |
| Drawn By: | JAY |
| Checked By: | TMG |
| Sheet: | |