

# EXHIBIT F. BEE BAYOU SITE, EXISTING AND PROPOSED POTABLE WATER INFRASTRUCTURE MAP

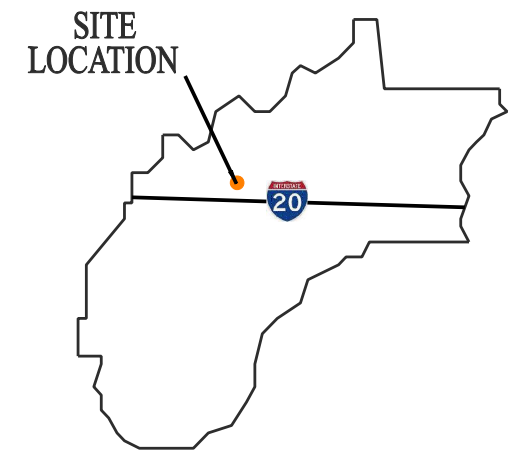
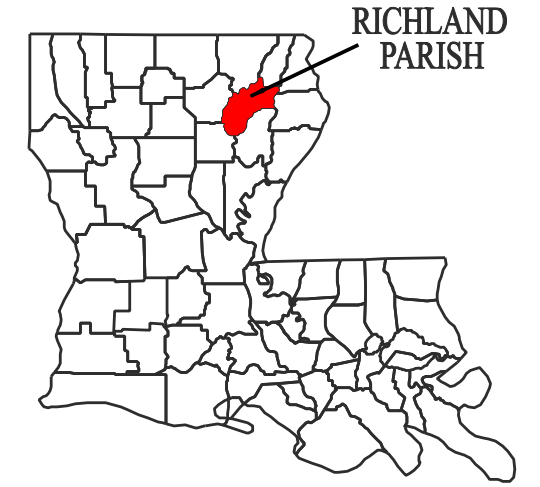
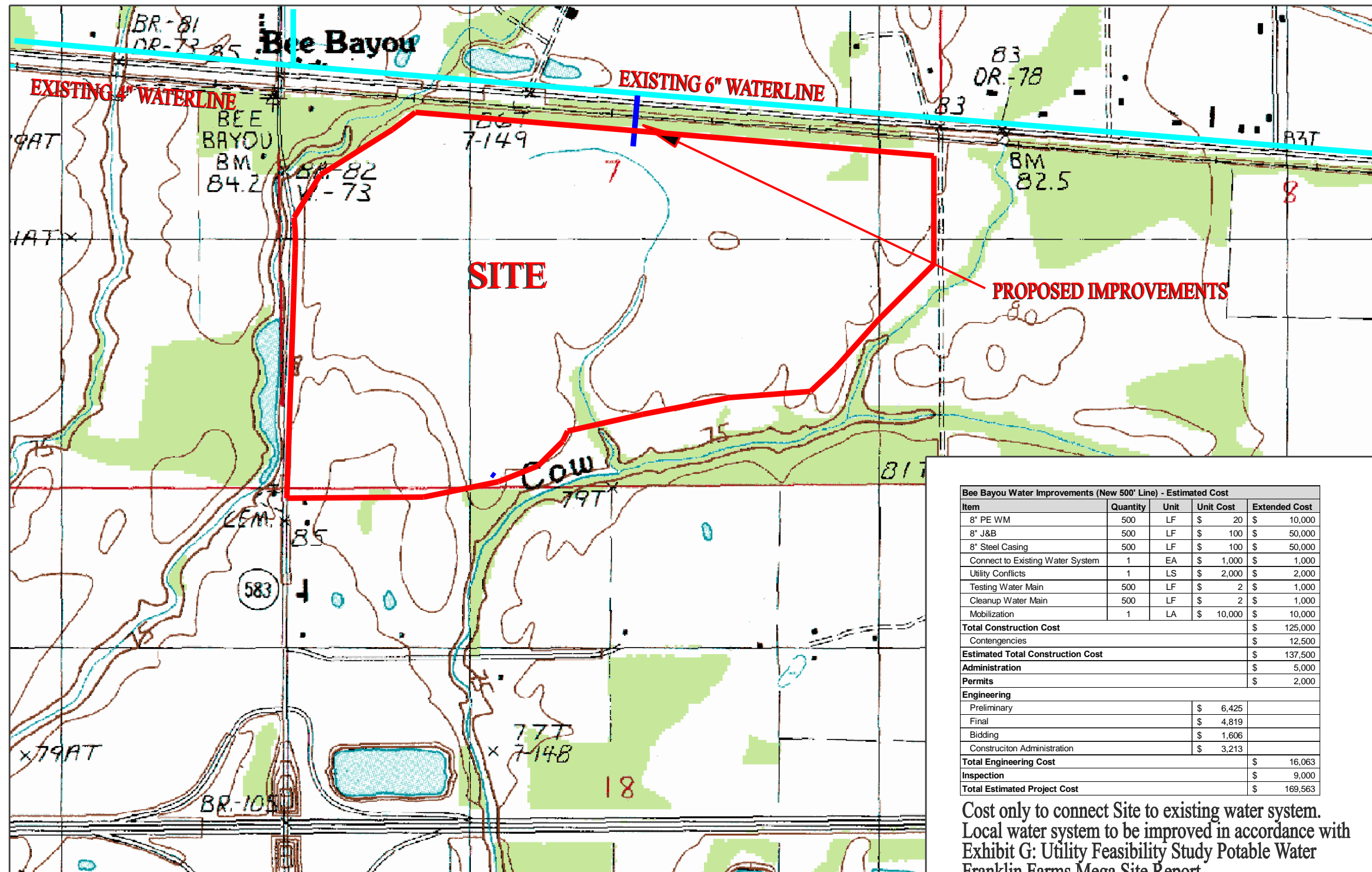

**Bee Bayou Water Improvements (New 500' Line) - Estimated Cost**

Item	Quantity	Unit	Unit Cost	Extended Cost
8" PE WM	500	LF	\$ 20	\$ 10,000
8" J&B	500	LF	\$ 100	\$ 50,000
8" Steel Casing	500	LF	\$ 100	\$ 50,000
Connect to Existing Water System	1	EA	\$ 1,000	\$ 1,000
Utility Conflicts	1	LS	\$ 2,000	\$ 2,000
Testing Water Main	500	LF	\$ 2	\$ 1,000
Cleanup Water Main	500	LF	\$ 2	\$ 1,000
Mobilization	1	LA	\$ 10,000	\$ 10,000
<b>Total Construction Cost</b>				\$ 125,000
Contingencies				\$ 12,500
<b>Estimated Total Construction Cost</b>				\$ 137,500
Administration				\$ 5,000
Permits				\$ 2,000
<b>Engineering</b>				
Preliminary			\$ 6,425	
Final			\$ 4,819	
Bidding			\$ 1,606	
Construction Administration			\$ 3,213	
<b>Total Engineering Cost</b>				\$ 16,063
Inspection				\$ 9,000
<b>Total Estimated Project Cost</b>				\$ 169,563

Cost only to connect Site to existing water system. Local water system to be improved in accordance with Exhibit G: Utility Feasibility Study Potable Water Franklin Farms Mega Site Report

**LEGEND**



Prepared By  
**DENMON ENGINEERING**  
 ENGINEERS AND SURVEYORS  
 114 VENABLE LANE  
 MONROE, LOUISIANA 71203