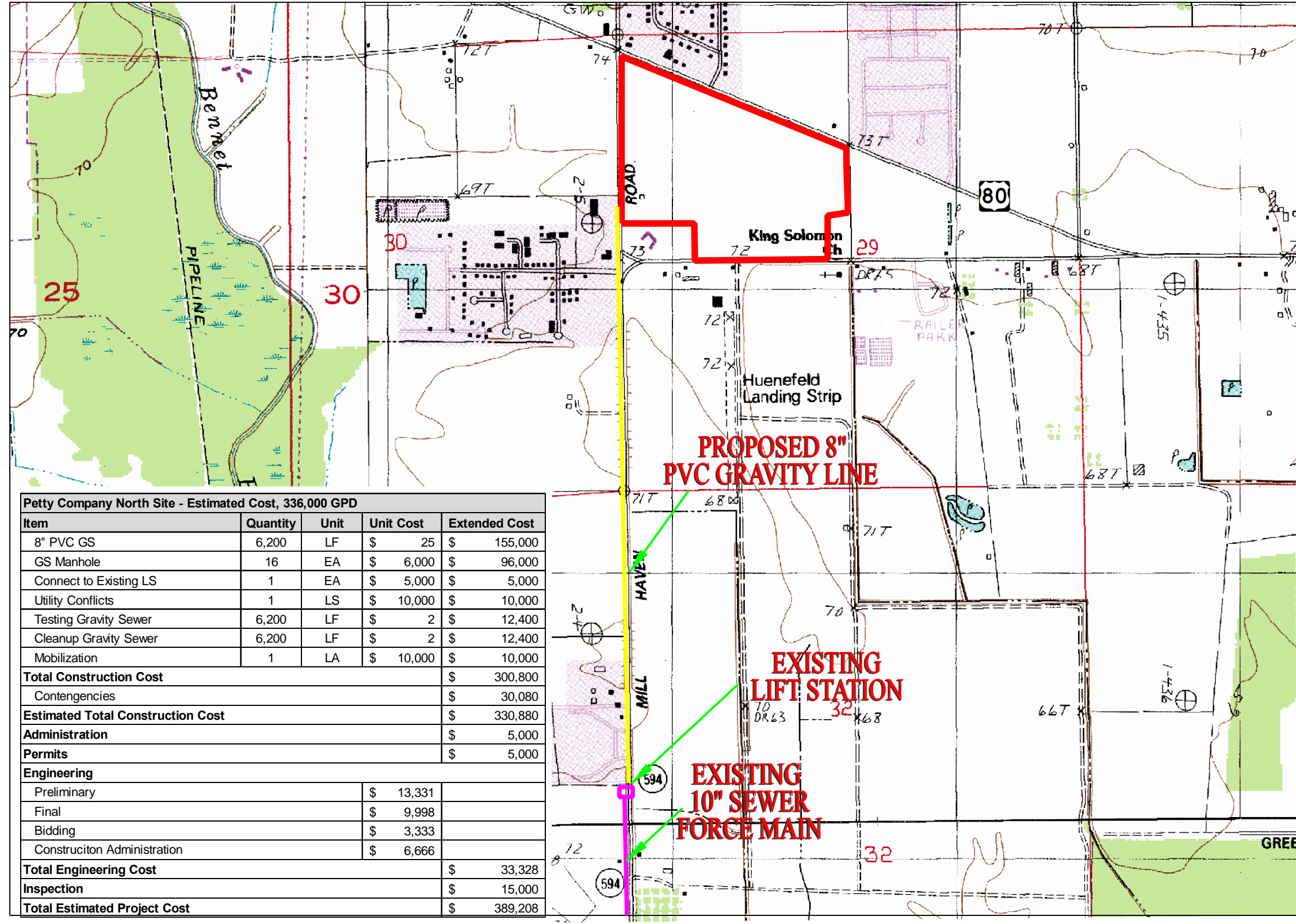
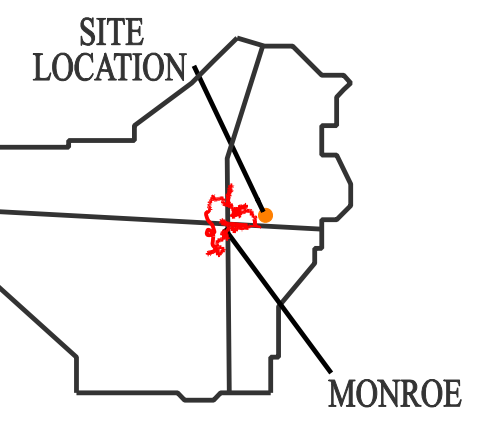

EXHIBIT G, PETTY NORTH SITE EXISTING & PROPOSED WASTEWATER INFRASTRUCTURE

OUACHITA
PARISH



Petty Company North Site - Estimated Cost, 336,000 GPD				
Item	Quantity	Unit	Unit Cost	Extended Cost
8" PVC GS	6,200	LF	\$ 25	\$ 155,000
GS Manhole	16	EA	\$ 6,000	\$ 96,000
Connect to Existing LS	1	EA	\$ 5,000	\$ 5,000
Utility Conflicts	1	LS	\$ 10,000	\$ 10,000
Testing Gravity Sewer	6,200	LF	\$ 2	\$ 12,400
Cleanup Gravity Sewer	6,200	LF	\$ 2	\$ 12,400
Mobilization	1	LA	\$ 10,000	\$ 10,000
Total Construction Cost				\$ 300,800
Contengencies				\$ 30,080
Estimated Total Construction Cost				\$ 330,880
Administration				\$ 5,000
Permits				\$ 5,000
Engineering				
Preliminary			\$ 13,331	
Final			\$ 9,998	
Bidding			\$ 3,333	
Construction Administration			\$ 6,666	
Total Engineering Cost				\$ 33,328
Inspection				\$ 15,000
Total Estimated Project Cost				\$ 389,208

LEGEND

— PROPERTY BOUNDARY



ECONOMIC ALLIANCE



Prepared By

DENMON
ENGINEERING
ENGINEERS AND SURVEYORS
114 VENABLE LANE
MONROE, LOUISIANA 71203

EXISTING CAPACITY, CITY OF MONROE, 336,000 GPD

SOURCE: USGS TOPOGRAPHIC QUAD MAP, MONROE NORTH, MONROE SOUTH, SWARTZ & CREW LAKE