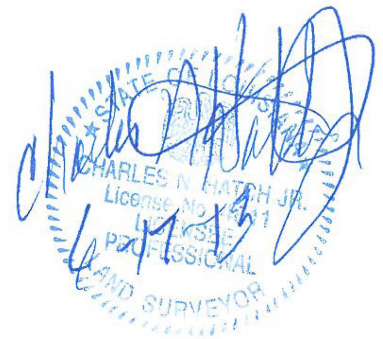

Exhibit D, Holly Ridge Northwest Site, Property Deed

JUNE 17, 2013

**EXHIBIT D
A LEGAL DESCRIPTION
OF
A 204.404 ACRE TRACT
FOR
GEORGE B. FRANKLIN & SON, INC (2/3)
JOHN C. MORRIS, III (1/3)
(TRACT II)
HOLLEY RIDGE NORTHWEST SITE
SITUATED IN
SECTIONS 10 & 15, T-17-N, R-8-E
RICHLAND PARISH, LOUISIANA**



Commencing from a concrete right of way monument on the North right of way of Interstate 20 situated in Section 15, T-17-N, R-8-E, Richland Parish Louisiana and being the POINT OF BEGINNING; thence, South 89°49'19" West along the North right of way of Interstate 20, a distance of 294.48' to a set 5/8" rebar with plastic cap; thence, leaving the said North right of way North 53°22'39" West, a distance of 113.37' to a set 5/8" rebar with plastic cap; thence, North 00°07'22" East, a distance of 353.48' to a set 5/8" rebar with plastic cap; thence, North 07°46'45" West, a distance of 995.03' to a set 5/8" rebar with plastic cap on the approximate ¼ section line; thence, East along the said ¼ section line, a distance of 1252.68' to a set 5/8" rebar with plastic cap intersecting the approximate ½ section line; thence, North along the said ½ section line, a distance of 2640.74' to a set 5/8" rebar with plastic cap on the South right of way of the KCS railroad; thence, South 85°12'06" East along the said South railroad right of way, a distance of 1868.65' to a set 5/8" rebar with plastic cap; thence, leaving the said right of way South 30°50'42" East, a distance of 167.03' to a set 5/8" rebar with plastic cap; thence, South 87°13'43" East, a distance of 395.92' to a set 5/8" rebar with plastic cap; thence, North 27°35'37" East, a distance of 132.05' to a set 5/8" rebar with plastic cap on the South right of way of the KCS railroad; thence, South 85°12'06" East along the said railroad right of way, a distance of 249.09' to a set 5/8" rebar with plastic cap on the West right of way of Louisiana Highway 183; thence, South 00°58'16" West along the said highway right of way, a distance of 151.47' to a set 5/8" rebar with plastic cap; thence, South 07°33'35" East along the said highway right of way, a distance of 101.12' to a set 5/8" rebar with plastic cap; thence, South 00°58'16"

1/2

West along the said highway right of way, a distance of 684.97' to a set 5/8" rebar with plastic cap; thence, leaving the West right of way of Louisiana Highway 183 South 35°37'52" West, a distance of 3225.47' to a set 5/8" rebar with plastic cap; thence, South 79°44'15" West, a distance of 550.53' to a set 5/8" rebar with plastic cap; thence, South 72°53'51" West, a distance of 241.63' to a set 5/8" rebar with plastic cap on the approximate ½ section line; thence, South 01°56'12" East along the said ½ section line, a distance of 94.96' to a set 5/8" rebar with plastic cap on the North right of way of Interstate 20; thence, South 89°51'02" West along the said Interstate 20 right of way, a distance of 736.50' back to a concrete right of way monument and the POINT OF BEGINNING and containing 204.404 acres more or less.

2/2

JUNE 17, 2013

**EXHIBIT D
A LEGAL DESCRIPTION
OF
A 77.159 ACRE TRACT
FOR
GEORGE B. FRANKLIN & SON, INC
(TRACT I)
HOLLEY RIDGE NORTHWEST SITE
SITUATED IN
SECTIONS 10 & 15, T-17-N, R-8-E
RICHLAND PARISH, LOUISIANA**



Commencing from a concrete right of way monument on the North right of way of Interstate 20 situated in Section 15, T-17-N, R-8-E, Richland Parish Louisiana; thence, South 89°49'19" West along the North right of way of Interstate 20, a distance of 294.48' to a set 5/8" rebar with plastic cap; thence, leaving the said North right of way North 53°22'39" West, a distance of 113.37' to a set 5/8" rebar with plastic cap; thence, North 00°07'22" East, a distance of 353.48' to a set 5/8" rebar with plastic cap; thence, North 07°46'45" West, a distance of 995.03' to a set 5/8" rebar with plastic cap on the approximate ¼ section line and being the POINT OF BEGINNING; thence, North 07°46'45" West, a distance of 207.61' to a set 5/8" rebar with plastic cap; thence, North 57°31'43" East, a distance of 391.42' to a set 5/8" rebar with plastic cap; thence, North 15°38'32" West, a distance of 606.98' to a set 5/8" rebar with plastic cap; thence, South 86°29'25" West, a distance of 225.72' to a set 5/8" rebar with plastic cap; thence, North 01°45'10" West, a distance of 708.97' to a set 5/8" rebar with plastic cap; thence, North 08°55'18" East, a distance of 229.16' to a set 5/8" rebar with plastic cap; thence, North 01°58'46" West, a distance of 683.54' to a set 5/8" rebar with plastic cap; thence, North 78°33'32" East, a distance of 148.54' to a set 5/8" rebar with plastic cap; thence, North 15°04'07" East, a distance of 108.99' to a set 5/8" rebar with plastic cap on the South right of way of the KCS railroad; thence, South 85°12'06" East along the said South railroad right of way, a distance of 1179.48' to a set 5/8" rebar with plastic cap on the approximate ½ section line; thence, leaving the said right of way South along the said ½ section line, a distance of 2640.74' to a set 5/8" rebar with plastic cap intersecting the approximate ¼ section line; thence,

1/2

West along the said $\frac{1}{4}$ section line, a distance of 1252.68' back to a set 5/8" rebar with plastic cap and the POINT OF BEGINNING and containing 77.159 acres more or less.

2/2